

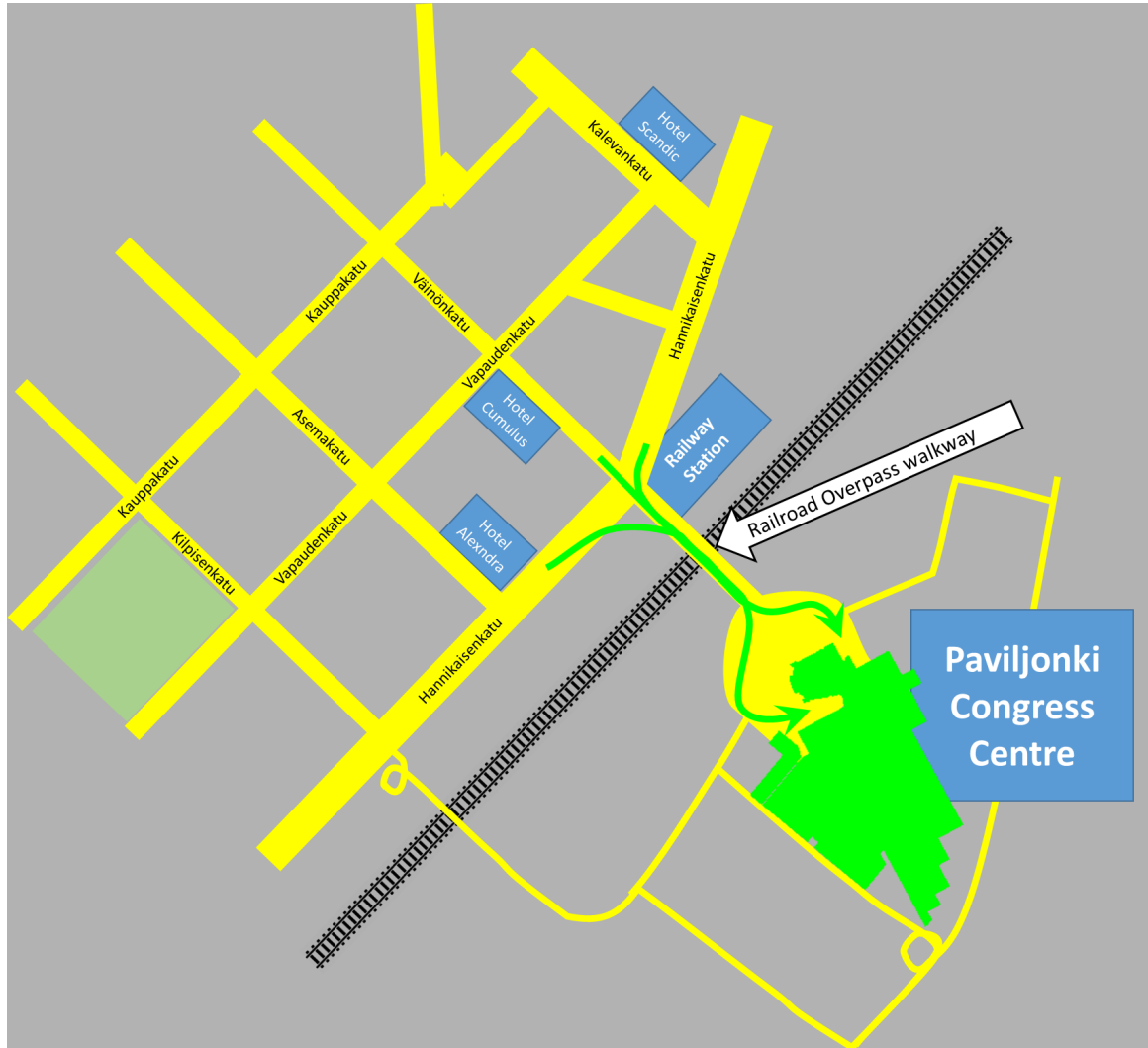

**5th European Congress of
Conservation Biology**

12th-15th of June 2018, Jyväskylä, Finland

Where is ECCB 2018?



Paviljonki Congress Centre: Floorplan

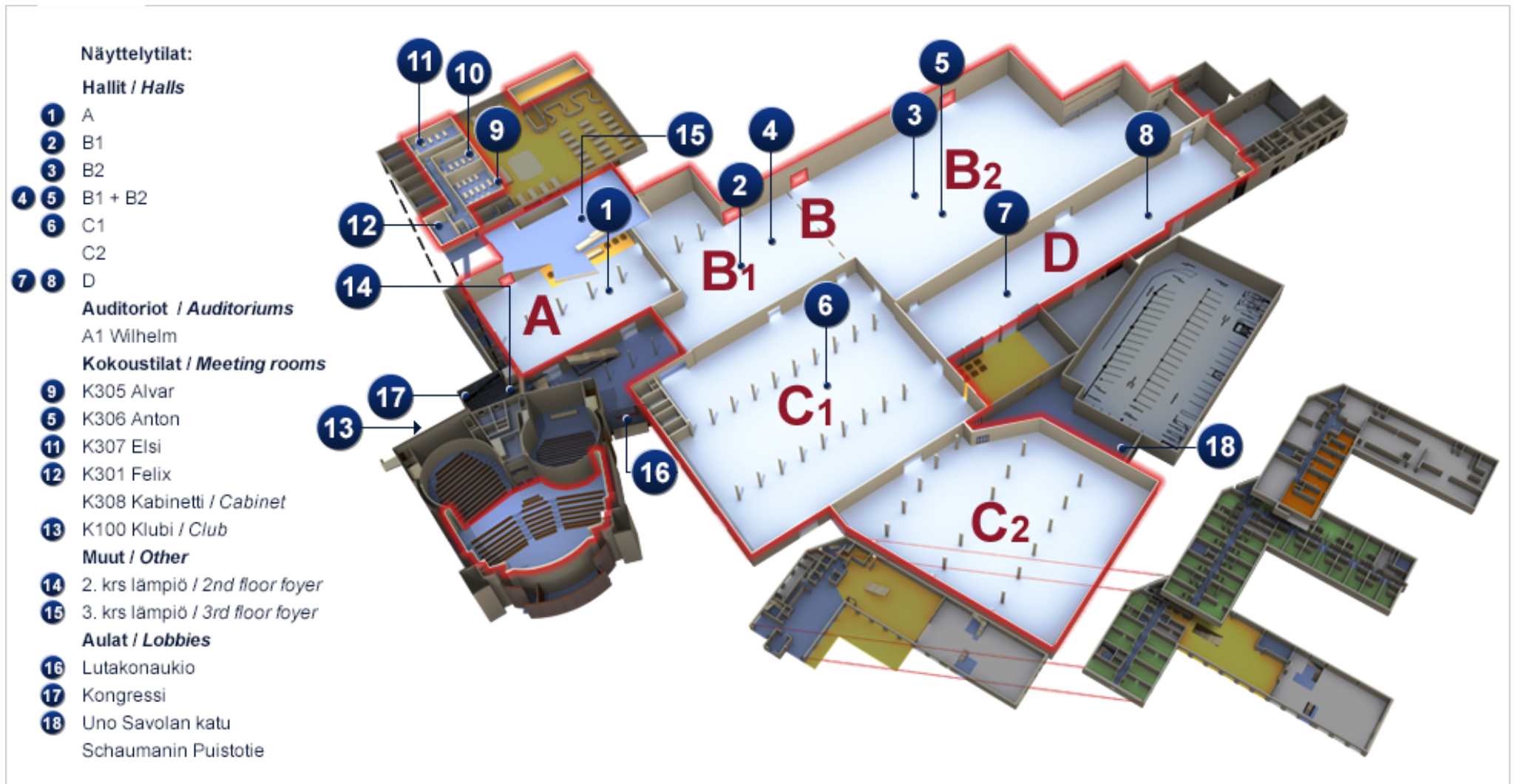

CONGRESS PROGRAM OVERVIEW

Monday 15:00

Registration Desk opens - Paviljonki Congress Centre

Monday 16:00

Icebreaker - Cash Bar - Paviljonki Congress Centre

Tuesday 08:30

ECCB 2018 opening - A1 Wilhelm

Tuesday 08:30

Plenaries:

Anne Larigauderie: Harnessing the power of science to save biodiversity

**Cristiana Paşca Palmer: Global biodiversity targets beyond 2020
- A1 Wilhelm**

Tuesday 10:30

Coffee - C1 Hall

Tuesday 11:00

A1 Wilhelm The trade-offs between forest use, climate mitigation and society I	A2 Wivi Ecosystem services	A3 Wolmar Human impacts on aquatic species and ecosystems	K308 Cabinet Understanding species distributions	K305 Alvar The diversity of Biodiversity Monitoring: aims, approaches, innovations, and policy contexts	K307 Elsi Grassland management	K306 Anton Key conservation issues in Mediterranean-type regions of the world: a focus on Europe and North Africa	K309 Gustaf Exploring the advances in using social media data for conservation science	K301 Felix Forest conservation beyond trees	C1 Hall Animal ecology and conservation I
------------------------------------------------------------------------------------------	--------------------------------------	---------------------------------------------------------------------	------------------------------------------------------------	-------------------------------------------------------------------------------------------------------------------	------------------------------------------	-----------------------------------------------------------------------------------------------------------------------------	--------------------------------------------------------------------------------------------------	-------------------------------------------------------	-----------------------------------------------------

Tuesday 13:00

Lunch

Tuesday 14:30

A1 Wilhelm The trade-offs between forest use, climate mitigation and society II; followed by Panel Discussion	A2 Wivi Biodiversity strongholds in a tamed landscape: new approaches to locate and conserve the last primary forests in Europe	A3 Wolmar Migratory salmonids as icons of conservation, restoration and rewilding of aquatic environments	K308 Cabinet Approaches to the global conservation crisis	K305 Alvar Connecting people and nature: the importance of diverse science communication	K307 Elsi Urban ecosystems	K306 Anton Ecosystem conservation	K309 Gustaf The future of conservation science through the eyes of young scientists	K301 Felix Bird conservation	C1 Hall Conservation, perceptions and policy
-------------------------------------------------------------------------------------------------------------------------	-------------------------------------------------------------------------------------------------------------------------------------------	---------------------------------------------------------------------------------------------------------------------	---------------------------------------------------------------------	----------------------------------------------------------------------------------------------------	--------------------------------------	---------------------------------------------	-----------------------------------------------------------------------------------------------	----------------------------------------	--------------------------------------------------------

Tuesday 16:30

Coffee and Poster Session - C1 Hall

Tuesday 18:30

Opening Reception with City of Jyväskylä - C1 Hall

Wednesday 08:30

Plenaries:

Kimmo Tiilikainen: Ecological compensations from the perspective of Finnish environmental administration, and the opening of the ecological compensation stakeholder day

**Atte Moilanen: The twelve operationally important decisions in offsetting: why do biodiversity offsets fail
- A1 Wilhelm**

Wednesday 10:30

Coffee - C1 Hall

Wednesday 11:00

A1 Wilhelm Stakeholder day: The No Net Loss Goal and challenges of biodiversity offsets implementation	A2 Wivi Forest natural disturbances and conservation	A3 Wolmar Alien and invasive species	K308 Cabinet Large carnivore ecology and conservation	K305 Alvar Social dimensions of conservation I	K307 Elsi To identify and manage climatic microrefugia and stepping stones	K306 Anton Technical workshop on environmental DNA in conservation management	K309 Gustaf Using experimental games to unlock conflicts between food security and biodiversity conservation	K301 Felix Finnish Environment Institute: Modern Use of Earth Observation Data	C1 Hall Conservation in agricultural landscapes
------------------------------------------------------------------------------------------------------------------	----------------------------------------------------------------	------------------------------------------------	-----------------------------------------------------------------	----------------------------------------------------------	--------------------------------------------------------------------------------------	-----------------------------------------------------------------------------------------	------------------------------------------------------------------------------------------------------------------------	------------------------------------------------------------------------------------------	-----------------------------------------------------------

Wednesday 13:00

Lunch

Wednesday 14:30

A1 Wilhelm Stakeholder day on ecological compensations	A2 Wivi Sustainable forests for the society of the future	A3 Wolmar Human-wildlife conflicts	K308 Cabinet Rewilding prospects for reconciling biodiversity restoration and human well-being	K305 Alvar Fish ecology and conservation	K307 Elsi Informed decision making for planetary wellbeing I: the challenge of science-policy-society interfacing in the European context	K306 Anton Environmental monitoring	K309 Gustaf Forests at risk: Bialowieza and beyond	K301 Felix Paths to efficient communication in conservation biology	C1 Hall Pollinator conservation
------------------------------------------------------------------	---------------------------------------------------------------------	----------------------------------------------	----------------------------------------------------------------------------------------------------------	----------------------------------------------------	-----------------------------------------------------------------------------------------------------------------------------------------------------	-----------------------------------------------	--------------------------------------------------------------	-------------------------------------------------------------------------------	-------------------------------------------

Wednesday 16:30

Coffee - C1 Hall

Wednesday 17:00

A1 Wilhelm
Stakeholder
day: Panel
discussion

A2 Wivi
Ecological
processes in
forest
ecosystems

A3 Wolmar
Evidence-
based
conservation

K308 Cabinet
Protected
areas

K305 Alvar
Publishing for
conservation

K307 Elsi
Informed
decision
making for
planetary
wellbeing II:
the challenge
of science-
policy-society
interfacing in
the European
context

K306 Anton
Ecological
interactions

K309 Gustaf
Remote
sensing for
conservation

K301 Felix
Plant ecology
and
conservation

C1 Hall
Biocultural
approaches to
conservation:
new tools for
involving
communities
and promoting
human-
environmental
wellbeing

**Minna
K302
and
Outside**
Nature-
based
intervention
and well-
being

Wednesday 19:00

Sauna Boats 1-2 - Outside

Wednesday 21:00

Society Jams Open Stage - Poppari (Puistokatu 2-4)

Wednesday 21:30

Sauna Boats 3-4 - Outside

Thursday 08:30

Plenary:

Madhur Anand: Let's talk about poetry at a conservation biology conference and see what happens - A1 Wilhelm

Thursday 09:30

Coffee - C1 Hall

Thursday 10:00

A1 Wilhelm Effects of conservation interventions on multiple ecosystem services: Co-benefits, trade-offs, and decision-making	A2 Wivi Conservation culturomics	A3 Wolmar Advances in approaches for evaluating conservation impacts and their strength and limitations	K308 Cabinet Forest management and biodiversity I	K305 Alvar Biodiversity offsetting	K307 Elsi The concept of Ecological solidarity : a tool to implement the planetary wellbeing	K306 Anton Animal ecology and conservation II	K309 Gustaf Conservation Telecouplings	K301 Felix Facilitating Planetary Well-Being through Collaboration with Faith Communities	C1 Hall The Green and the Grey: roadless areas and future mobility
-----------------------------------------------------------------------------------------------------------------------------------------	--------------------------------------------	-------------------------------------------------------------------------------------------------------------------	-------------------------------------------------------------	----------------------------------------------	--------------------------------------------------------------------------------------------------------	---------------------------------------------------------	--------------------------------------------------	-----------------------------------------------------------------------------------------------------	------------------------------------------------------------------------------

Thursday 12:00

Lunch

Open Equity, Inclusion & Diversity Lunch Discussion

Thursday 13:30

A1 Wilhelm Agroecology: Policy and Governance	A2 Wivi Best practices in increasing biodiversity in European forests on a landscape scale	A3 Wolmar Conservation and management of transboundary large carnivore populations: challenges and opportunities	K308 Cabinet Advancing conservation biology	K305 Alvar Open invitation: Group discussion on biodiversity offsetting experiences, risks and possibilities	K307 Elsi Marine conservation	K306 Anton Wildlife conservation in Africa and Asia	K309 Gustaf Free	K301 Felix Does EU matter for Conservation? The Birds and Habitats directives from a Nordic perspective	C1 Hall Social dimensions of conservation II
---------------------------------------------------------	------------------------------------------------------------------------------------------------------	----------------------------------------------------------------------------------------------------------------------------	-------------------------------------------------------	------------------------------------------------------------------------------------------------------------------------	-----------------------------------------	---------------------------------------------------------------	----------------------------	-------------------------------------------------------------------------------------------------------------------	--------------------------------------------------------

Thursday 15:30

Coffee and Poster Session SCB-ES General Assembly - C1 Hall

Thursday 16:30

A1 Wilhelm
Reconciling conservation, ecosystem services and crop production in agricultural landscapes – the role of ecological intensification

A2 Wivi
Natural disturbance emulation in forest conservation and sustainable ecosystem management

A3 Wolmar
Did it matter? On measuring the impact of Conservation Biology research.

K308 Cabinet
The power of citizen science and big data to advance fungal conservation

K305 Alvar
Large carnivores and zoos as catalysts for biodiversity conservation: how do we engage the public in the protection of biodiversity?

K307 Elsi
Infrastructure and conservation

K306 Anton
Towards sustainable businesses: Insights to sustainable corporate strategies and business models

K309 Gustaf
Free

K301 Felix
Conservation Innovation: From Grassroots to Governments

C1 Hall
Conservation planning

Thursday 19:00

Lake Jyväsjärvi Run - Outside

Thursday 19:00

Sauna Boats 1-2 - Outside

Thursday 19:30

Movie Night - Agora Building

Thursday 21:30

Sauna Boats 3-4 - Outside

Friday 08:30

Plenaries:

Virgilio Hermoso: Future of freshwater ecosystems: utopia or dystopia in the face of climate change?

**Luis Arranz: The war of conservation
- A1 Wilhelm**

Friday 09:30

Coffee - C1 Hall

Friday 10:00

A1 Wilhelm

Evidence for forest biodiversity conservation: Recent scientific advances and future perspectives in temperate forests

A2 Wivi

Conservation under global change

A3 Wolmar

New Perspectives on the Natural Environment and Human Wellbeing in the Context of the Sustainable Development Goals

K308 Cabinet

To manage or not to manage? – Effects of active interventions on forest biodiversity

K305 Alvar

Conservation of freshwater ecosystems

K307 Elsi

Open Data in Conservation Biology

K306 Anton

From fungi to flies: broadening the use of functional traits in conservation

K309 Gustaf

Free

K301 Felix

Biodiversity conservation and sustainable community well-being in China – challenges and opportunities

C1 Hall

A quick guide to IPBES, with special reference to the Europe Central Asia Assessment

Friday 12:00

Lunch

Friday 13:30

A1 Wilhelm
From
Conservation
Genetics to
Conservation
Genomics to
Synthetic
Biodiversity

A2 Wivi
Climate
change effects
and adaptation

A3 Wolmar
Animal
ecology and
conservation
III

K308 Cabinet
Integrated
solutions for
increased
planetary
wellbeing by
restoring
degraded
habitats

K305 Alvar
Forest
management
and
biodiversity II

K307 Elsi
Participating
in and
building on
IPBES
assessments in
research and
in policy

K306 Anton
Woodpeckers
as surrogate
species to
support forest
biodiversity
conservation
in a changing
world

K309 Gustaf
Conservation
policies and
tools

K301 Felix
Ecosystem
Services as
Effective
Environmental
Management
Tool for
Conservation
Biology

C1 Hall
Connectivity
Conservation -
safeguarding
the future in a
matrix of
human-
dominated
landscapes

Friday 15:30

Coffee and Poster Session - C1 Hall

Friday 17:00

Plenary:

**Will Steffen: The Anthropocene, Planetary Boundaries and the Biosphere: Challenges of the 21st Century
- A1 Wilhelm**

Friday 19:00

Conference Banquet at Harbour Night Festival - Outside